

# Enclosure Accessories - Hubs, Grounding Plates, and Grounding Bushings

## Myers Hubs\*

### Ground Hub Basic Scru-Tite®

Zinc

ATEX Approval with DEMKO 07 ATEX 0618172U

II 2 G Ex e II

Class I, Zone 1, AEx e II

UL File No. 187273

Class I, Zone 1, Ex e II



| Cat. # | Size   | Unit Qty. | Wt. Lbs.<br>Per 100 |
|--------|--------|-----------|---------------------|
| STGK 1 | 1/2"   | 10        | 20                  |
| STGK 2 | 3/4"   | 10        | 30                  |
| STGK 3 | 1"     | 10        | 43                  |
| STGK 4 | 1 1/4" | 5         | 55                  |
| STGK 5 | 1 1/2" | 5         | 73                  |
| STGK 6 | 2"     | 5         | 95                  |

### Stainless Steel – Type 316

ATEX Approval with DEMKO 07 ATEX 0618172U

II 2 G Ex e II

Class I, Zone 1, AEx e II

UL File No. E-187273

Class I, Zone 1, Ex e II



| Cat. #  | Size   | Unit Qty. | Wt. Lbs.<br>Per 100 |
|---------|--------|-----------|---------------------|
| SSTGK 1 | 1/2"   | 10        | 20                  |
| SSTGK 2 | 3/4"   | 10        | 30                  |
| SSTGK 3 | 1"     | 10        | 43                  |
| SSTGK 4 | 1 1/4" | 5         | 55                  |
| SSTGK 5 | 1 1/2" | 5         | 73                  |
| SSTGK 6 | 2"     | 5         | 95                  |

### Metric To NPT Adapter

Zinc

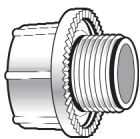

| Cat. # | Size          | Unit Qty. | Wt. Lbs.<br>Per 100 |
|--------|---------------|-----------|---------------------|
| STM 1  | M20 to 1/2"   | 25        | 12                  |
| STM 2  | M25 to 3/4"   | 25        | 32                  |
| STM 3  | M32 to 1"     | 25        | 32                  |
| STM 4  | M40 to 1 1/4" | 10        | 40                  |
| STM 5  | M50 to 1 1/2" | 10        | 50                  |
| STM 6  | M63 to 2"     | 10        | 70                  |

**Note:** The Myers Metric to NPT hub adapter is used to convert a threaded metric entry to a NPT entry. The female thread is NPT and the male thread is metric.

### Metric To NPT Adapter

Stainless Steel

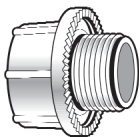

| Cat. # | Size          | Unit Qty. | Wt. Lbs.<br>Per 100 |
|--------|---------------|-----------|---------------------|
| SSTM 1 | M20 to 1/2"   | 10        | 12                  |
| SSTM 2 | M25 to 3/4"   | 10        | 20                  |
| SSTM 3 | M32 to 1"     | 10        | 32                  |
| SSTM 4 | M40 to 1 1/4" | 5         | 40                  |
| SSTM 5 | M50 to 1 1/2" | 5         | 50                  |
| SSTM 6 | M63 to 2"     | 5         | 70                  |

## Nonmetallic Hubs

*Krydon*® material hubs for conduit entrances, in sizes 1/2" through 3" are available for factory or field installation in all enclosures made of *Krydon* material. For factory installation, send drawing showing sizes and locations of hubs. Furnished with and gaskets to assure.

### Standard Materials:

- Up to 1 1/2" – *Krydon* material with steel interiors
- 2", 2 1/2" and 3" – *Krydon* material with *Feraloy*® iron alloy interiors

### Standard Finishes:

- *Krydon* material – natural
- Steel – electrogalvanized and bleached chromate
- *Feraloy* iron alloy – electrogalvanized

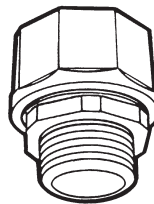

| Conduit Size | Hole Size | Hub Cat. # |
|--------------|-----------|------------|
| 1/2"         | 7/8"      | NHUB1      |
| 3/4"         | 1 1/8"    | NHUB2      |
| 1"           | 1 3/8"    | NHUB3      |
| 1 1/4"       | 1 3/4"    | NHUB4      |
| 1 1/2"       | 2"        | NHUB5      |
| 2"           | 2 1/2"    | NHUB6      |
| 2 1/2"       | 3"        | NHUB7      |
| 3"           | 3 5/8"    | NHUB8      |

## Grounding Plates and Grounding Bushings

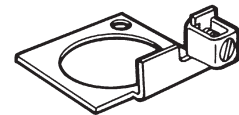
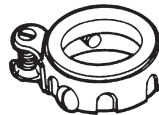

Grounding Plates (1/2" through 1") and insulated bushings (1/2" through 3") permit use of the conduit as the grounding circuit. Both types have set screws and ground-wire terminals.

### Standard Materials:

- Grounding plates – steel
- Grounding bushings – steel with thermoplastic insulating throat

### Standard Finishes:

- Steel – electrogalvanized

| Conduit Size | Grounding Plate Cat. # | Grounding Bushing Cat. # |
|--------------|------------------------|--------------------------|
| 1/2"         | GP1                    | GLS1                     |
| 3/4"         | GP2                    | GLS2                     |
| 1"           | GP3                    | GLS3                     |
| 1 1/4"       |                        | GLS4                     |
| 1 1/2"       |                        | GLS5                     |
| 2"           |                        | GLS6                     |
| 2 1/2"       |                        | GLS7                     |
| 3"           |                        | GLS8                     |

\*For a complete list of Myers Hubs available from Eaton's Crouse-Hinds, refer to Section CP.