

This drawing is the property of MELTRIC Corporation, Franklin (Milwaukee), Wisconsin, USA. Any unauthorized copying of this drawing by any means, or disclosure of its contents to any person not authorized by MELTRIC Corporation or its agents to receive it, is strictly prohibited.

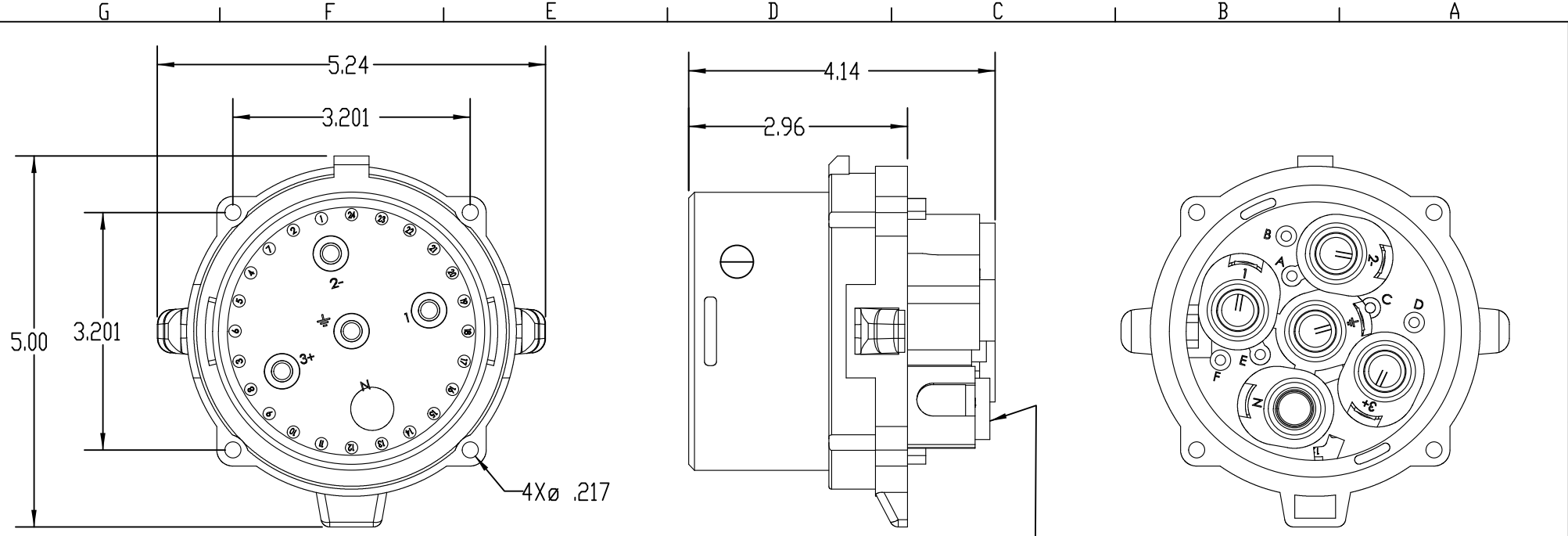

600VDC DEVICES WILL HAVE JUMPERS & EXTRA CONTACTS.

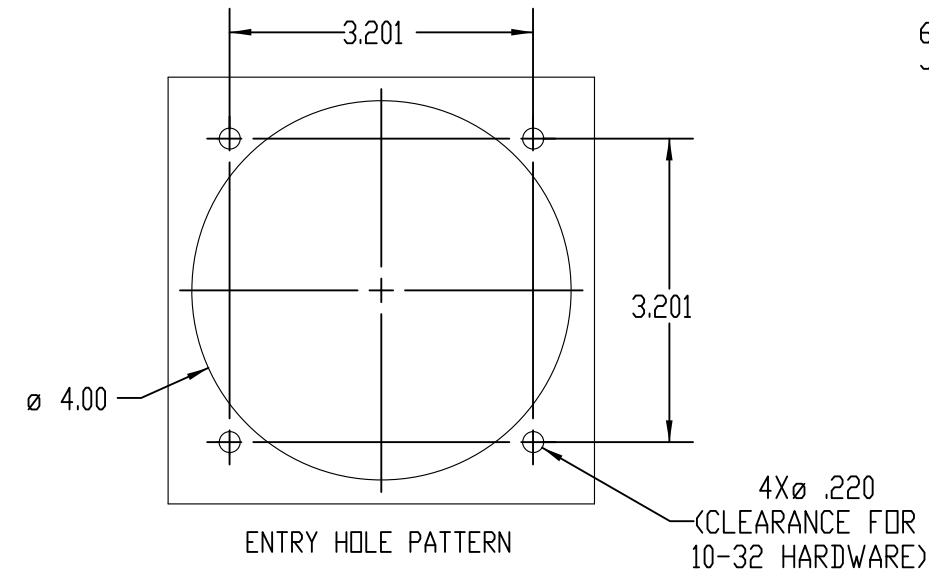

ENTRY HOLE PATTERN

TOLERANCES UNLESS OTHERWISE SPECIFIED		<b>MELTRIC CORPORATION</b> DRAWN: _____ APPROVED: _____ DATE: _____ SCALE: NTS MATERIAL: METAL CASING SHEET: 1 OF 1 PART NUMBER: 37-98x09 REVISION: _____	
MACHINED SURFACES	125/32 MAX		
GROUND SURFACES	32/32 MAX	0.X ±0.05	
ANGLE TOLERANCE	±1°	0.XX ±0.01	
REMOVE BURRS & SHARP EDGES TO .015 MAX.		0.XXX ±0.005	
DIMENSIONS SHOWN IN OVALS ARE INSPECTION DIMENSIONS.			