

# MULTIPIN DXN25c/DXN37c

## PRODUCT FEATURES

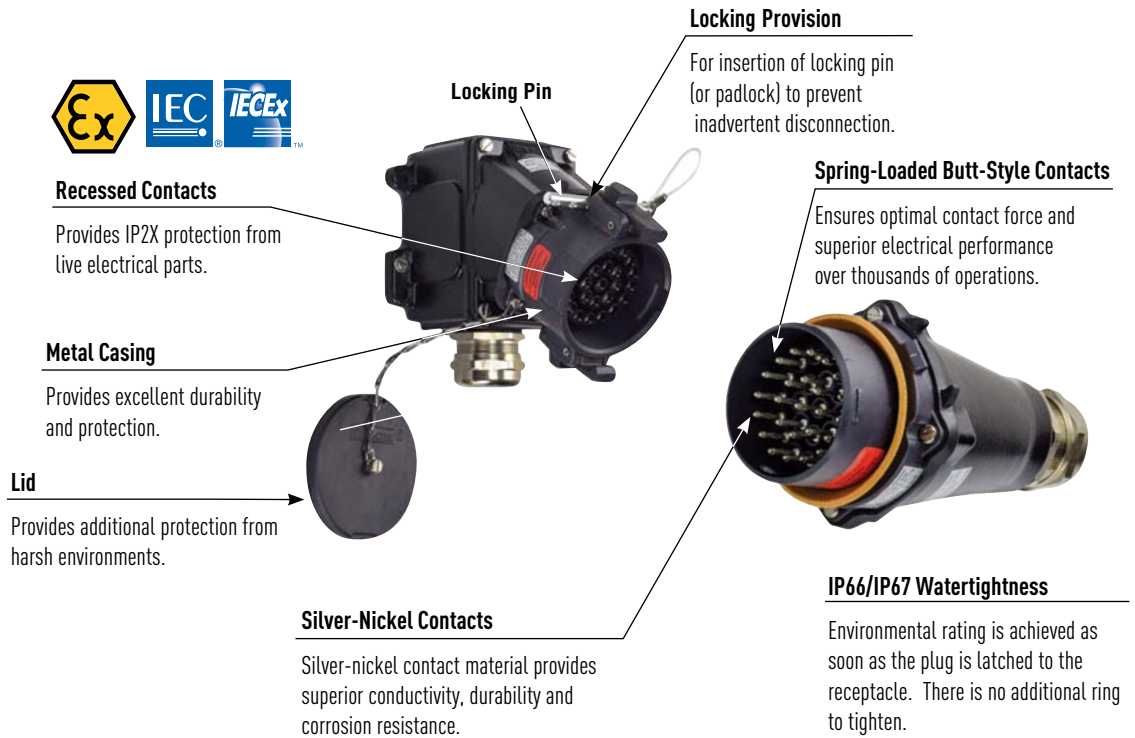

## Hazardous Location Listings

ATEX			
II 2 GD Ex e IIC Gb Ex tb IIIC Db Suitable for Zone 1 & 2 (gas) 21 & 22 (dust)			
Ex ia or ib IIC T6 Gb			
DXN25c	-40°C ≤ Ta ≤ +60°C	T5	T71°C
	-40°C ≤ Ta ≤ +40°C	T6	T51°C
	IECEX LCIE 14.0040X/LCIE 09 ATEX 3050X		
DXN37c	-40°C ≤ Ta ≤ +55°C	T5	T76°C
	-40°C ≤ Ta ≤ +40°C	T6	T56°C
	IECEX LCIE 14.0038X/LCIE 07 ATEX 6071X		

### Highlighted Feature

- Crimped Contacts**  
 DXN25c/DXN37c devices now feature contacts that can be crimped or soldered. Each device is supplied with 26 or 39 contacts so that the product can be set up to suit application needs.

## Simple Assembly and Disassembly

DSN37c shown

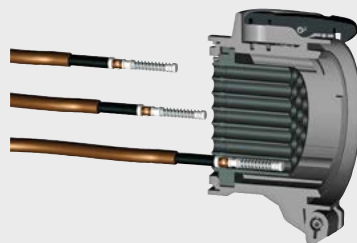

### Assembly

To insert contacts when they have been wired is simple. Push wired contact into rear of insulator until it stops to complete the installation.



### Disassembly

To remove, use the tool provided. Push tool from front onto contact until tool stops. Contact is then released at rear of insulator.

# DXN25C/37C Hazardous Location Multipin – 10 A

Devices rated for hazardous locations are not returnable.

### Ratings

- **Voltage**  
440 VAC or VDC DXN25c  
230 VAC or VDC DXN37c
- **Amperage Ratings**  
10 A DXN25c Not for disconnection of a live circuit  
10 A DXN37c Not for disconnection of a live circuit
- **Environmental Ratings**  
IP66/IP67
- **Temperature Range**  
Min -40°F/Max 131°F – (DXN25c)  
Min -40°F/Max 131°F – (DXN37c)  
See pg 256 for temps below -15°F.
- **Wiring Capacity**  
Min 16 AWG Max 14 AWG  
\* Based on THHN wiring connection type solder
- **Terminal Type**  
DXN25c: Solder/Crimp  
DXN37c: Solder/Crimp
- **Applicable Standards**  
ATEX, IECEx

### Connector (female recept w/handle)



or

### Receptacle/Angle (female)



or

### Recept/Angle/Box (female)



Voltage	Polarity	Cable Range	Part # Metal	Part # Metal	Part # Metal
440V	24P+G	.47 - .825"	36-D3002-32M	36-D7002	36-D0002-32M
440V	24P+G	.63 - 1.063"	36-D3002	36-D7002	36-D0002
220V	36P+G	.47 - .825"	36-C3003-32M	36-C7003	36-C0003-32M
220V	36P+G	.63 - 1.063"	36-C3003	36-C7003	36-C0003

For international configurations (IEC/CE) visit [meltric.com/international-catalog](http://meltric.com/international-catalog) or contact customer service at 800-433-7642.

### Plug (male inlet w/handle)



or

### Inlet/Angle (male)



or

### Inlet/Angle/Box (male)



Voltage	Polarity	Cable Range	Part # Metal	Part # Metal	Part # Metal
440V	24P+G	.47 - .825"	36-D1002-32M	36-D9002	36-D6002-32M
440V	24P+G	.63 - 1.063"	36-D1002	36-D9002	36-D6002
220V	36P+G	.47 - .825"	36-C1003-32M	36-C9003	36-C6003-32M
220V	36P+G	.63 - 1.063"	36-C1003	36-C9003	36-C6003

For international configurations (IEC/CE) visit [meltric.com/international-catalog](http://meltric.com/international-catalog) or contact customer service at 800-433-7642.

### ACCESSORIES

#### MULTI-CONTACT REMOVAL TOOL



61-CA593

#### EUROPEAN CRIMPING TOOL



61-CA500

#### BAG OF 13 FEMALE CONTACTS



01-AA213

Includes insulation sleeves and ferrules

#### PLUG CAP



31-3A426

#### CRIMPER TOOL (Greenlee or equal)



4CN30

#### BAG OF 13 MALE CONTACTS



61-CA113

Includes insulation sleeves and ferrules

# DXN25C/37C DIMENSIONS – Provided in inches

Dimensions are for reference only and may change depending on accessories used. For precise dimensions contact MELTRIC Engineering.

### plug

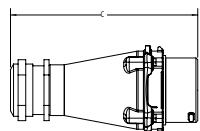
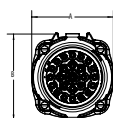

### wall box/angle/ receptacle/plug

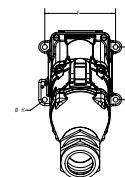
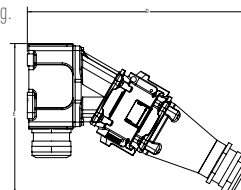

PRODUCT	A	B	C	D	E	F	G	øH
DXN25C/DXN37C	3.17	3.35	7.26	11.64	7.83	3.7	2.76	0.26